

WHITAKER, SELLERS & DUROS TIMBER SALE NOTICE

Buck Knob Ln, Loogootee, IN 47553

County: Martin

State: Indiana

Date: Friday, December 1, 2017 @ 10:00 AM Eastern (Martin County time). Bid opening is at the intersection of Killion Mill Rd and Buck Knob Ln. near the property entrance. **See map on back**

Type of Sale: Sealed or phone bids. Twenty five percent down at contract signing, balance due by Sept. 1, 2018 or before logging begins, whichever comes first. Buyer will have until **July 1, 2019** to remove the timber.

Owner: Patricia Whitaker, Pamela Sellers and Robert & Paula Duros

Location: Approximately 6.4 miles northeast of Loogootee and 5.6 miles northwest of Shoals in the NW¹/₄ of Section 35, T4N, R4W in Center Township. From the intersection of US 231 and US 50 in Loogootee (at McDonalds), go east on US 50 about 2.25 miles to Dover Hill Rd. Turn north on Dover Hill Rd and go 4.6 miles to Killion Mill Rd. Turn north on Killion Mill, go 0.8 miles and turn onto Buck Knob Ln. This intersection is where the bid opening will be. The property is accessed about 0.4 miles down Buck Knob Ln. The marked timber is to the right of this road. If coming from the east take SR 450 north from US 50 and turn onto Dover Hill Rd. on the south side of Dover Hill. After 0.9 miles turn onto Killion Mill Rd and continue to Buck Knob Ln. **See map on back.**

Contact: Multi-Resource Management, Inc., 4870 N Park Lane Dr., Petersburg, IN 47567

e-mail: multiresource@frontier.com

Thom Kinney 812-483-4818 (C) 812-354-6472 (H)

Doug Brown 812-639-9724 (C) 812-326-2243 (H)

Remarks: Trees are marked with **blue** paint. Seller reserves the right to accept or reject any or all bids. The owner and their agents make no guarantees of the board feet, number, or quality of trees listed in the timber tally. Bidders are urged to satisfy themselves as to type, quality, and quantity of timber offered for sale. Buyer must have an Indiana timber buyer's license. Best management logging practices are required during the harvest operation. Purchaser will be required to carry general liability insurance & workers' compensation. **A summary of diameter and volume distributions by species is available upon request.**

TIMBER TALLY

SPECIES	# OF TREES	EST. VOLUME
Red Oak	7	2,754
Black Oak	58	19,023
White Oak*	59	17,521
Walnut	1	207
Tuliptree	162	57,901
Hard Maple	23	3,703
Soft Maple	12	1,798
Scarlet Oak	3	1,151
Hickory	49	9,646
Misc.**	13	1,612
Subtotals	387	115,316
Culls (X'd trees)	149	No Vol. Figured
TOTALS	536	115,316

* Includes 2 white oaks with blue "V" for veneer potential.

** Misc. includes 5 beech, 1 sycamore, 2 post oak, 3 blackgum, 1 ash and 1 red elm

Whitaker, Sellers & Duros Property

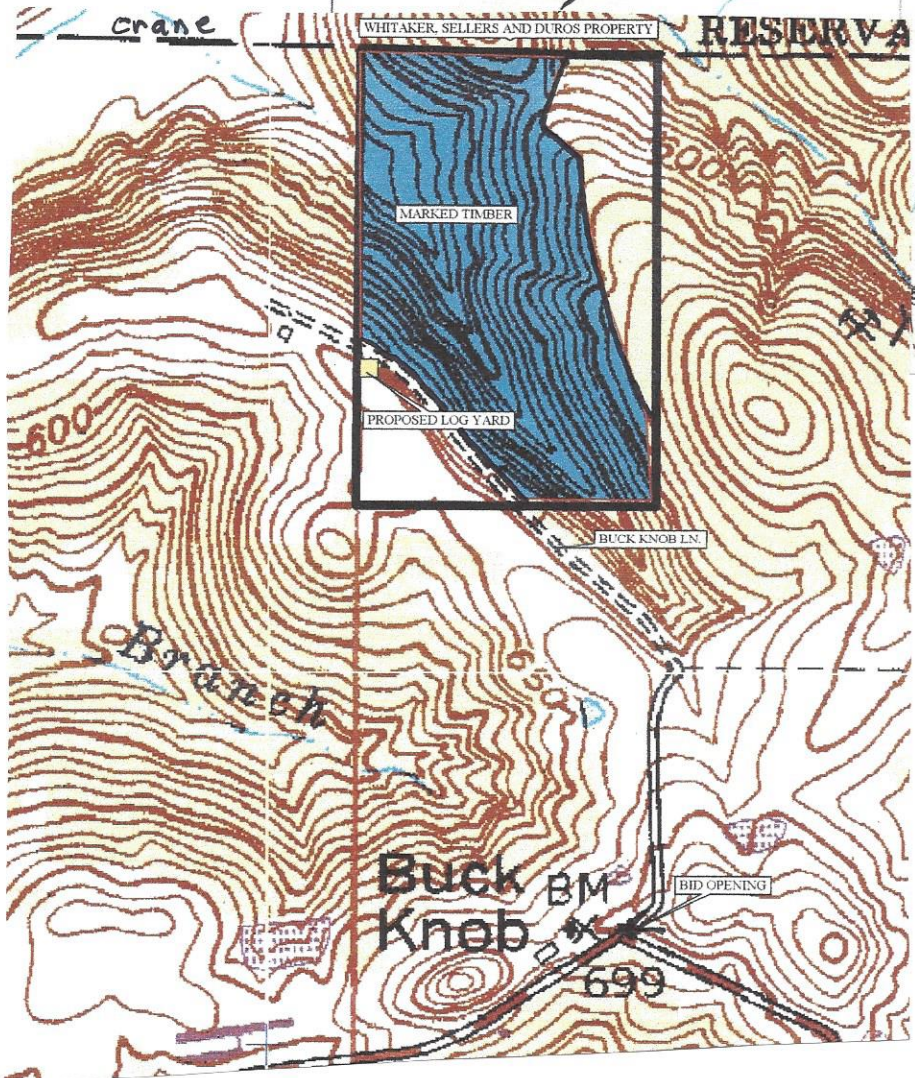
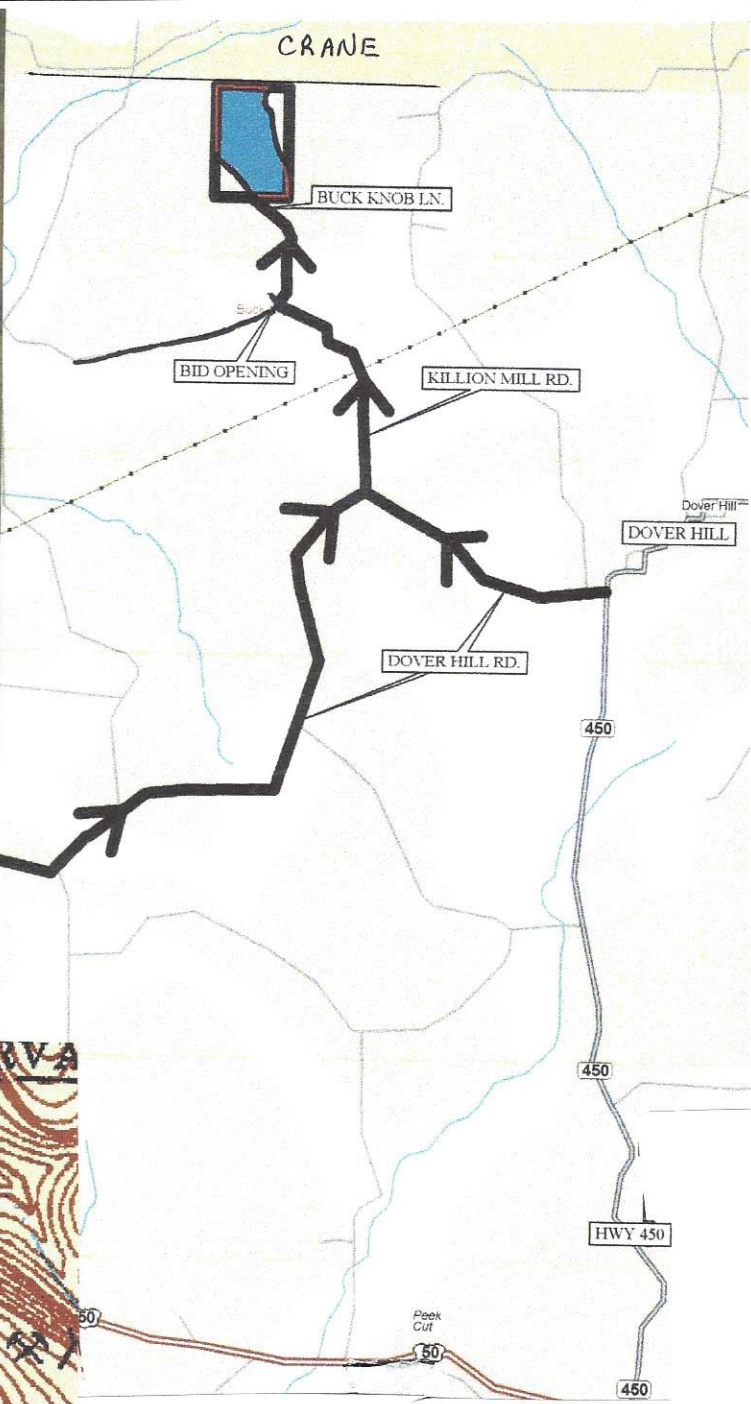

Whitaker, Sellers, Duros
Sale Map

Whitaker, Sellers & Duros
 Buck Knob Tract
 Martin County, Indiana

Stand Number: 1
 Number Acres: 41.0
 100% Inventory

Total

Red Oak			Black Oak			White Oak			Black Walnut			Tuliptree		
Hardwood Sawtimber			Hardwood Sawtimber			Hardwood Sawtimber			Hardwood Sawtimber			Hardwood Sawtimber		
DBH	Trees	Vol	DBH	Trees	Vol	DBH	Trees	Vol	DBH	Trees	Vol	DBH	Trees	Vol
4			4			4			4			4		
5			5			5			5			5		
6			6			6			6			6		
7			7			7			7			7		
8			8			8			8			8		
9			9			9			9			9		
10			10			10			10			10		
11			11			11			11			11		
12			12			12			12			12		
13			13			13			13			13		
14			14	1.00	41.00	14	1.00	72.00	14			14	6.00	432.00
15			15	4.00	358.00	15			15			15	16.00	1,773.00
16	1.00	110.00	16	5.00	592.00	16	7.00	735.00	16			16	7.00	1,052.00
17			17	1.00	103.00	17	2.00	278.00	17			17	16.00	3,067.00
18			18	4.00	788.00	18	7.00	1,105.00	18	1.00	207.00	18	19.00	3,977.00
19			19	5.00	1,064.00	19	5.00	1,131.00	19			19	9.00	2,567.00
20			20	6.00	1,420.00	20	4.00	983.00	20			20	17.00	5,728.00
21	1.00	225.00	21	3.00	985.00	21	4.00	881.00	21			21	14.00	5,169.00
22	1.00	255.00	22	3.00	1,257.00	22	7.00	1,509.00	22			22	17.00	7,124.00
23	1.00	228.00	23	9.00	3,530.00	23			23			23	7.00	3,219.00
24			24	7.00	3,263.00	24	6.00	2,194.00	24			24	9.00	4,972.00
25	1.00	505.00	25	4.00	1,655.00	25	6.00	2,573.00	25			25	6.00	3,717.00
26	1.00	702.00	26	3.00	1,722.00	26	4.00	2,057.00	26			26	5.00	2,776.00
27			27			27	4.00	2,256.00	27			27	2.00	1,535.00
28			28	1.00	382.00	28	1.00	922.00	28			28	5.00	4,195.00
29	1.00	729.00	29			29	1.00	825.00	29			29	2.00	1,830.00
30			30	1.00	997.00	30			30			30	3.00	2,889.00
31			31			31			31			31	1.00	1,080.00
32			32			32			32			32	1.00	799.00
33			33	1.00	866.00	33			33			33		
34			34			34			34			34		
35			35			35			35			35		
36			36			36			36			36		
37			37			37			37			37		
38			38			38			38			38		
39			39			39			39			39		
40			40			40			40			40		
7.00	2,754.00		58.00	19,023.00		59.00	17,521.00		1.00	207.00		162.00	57,901.00	
Avg Vol 393.43			Avg Vol 327.98			Avg Vol 296.97			Avg Vol 207.00			Avg Vol 357.41		

Hard Maple			Soft Maple			Ash			Scarlet Oak			Hickory		
Hardwood Sawtimber			Hardwood Sawtimber			Hardwood Sawtimber			Hardwood Sawtimber			Hardwood Sawtimber		
DBH	Trees	Vol	DBH	Trees	Vol	DBH	Trees	Vol	DBH	Trees	Vol	DBH	Trees	Vol
4			4			4			4			4		
5			5			5			5			5		
6			6			6			6			6		
7			7			7			7			7		
8			8			8			8			8		
9			9			9			9			9		
10			10			10			10			10		
11			11			11			11			11		
12			12			12			12			12		
13			13			13			13			13		
14	2.00	82.00	14	2.00	82.00	14	1.00	84.00	14			14	6.00	441.00
15	3.00	280.00	15			15			15	1.00	105.00	15	6.00	602.00
16	1.00	110.00	16			16			16			16	7.00	837.00
17	5.00	674.00	17	4.00	439.00	17			17			17	7.00	969.00
18	3.00	410.00	18			18			18			18	5.00	758.00
19	2.00	382.00	19			19			19			19	4.00	1,065.00
20	1.00	277.00	20	2.00	355.00	20			20			20	2.00	515.00
21	3.00	716.00	21	1.00	176.00	21			21	1.00	353.00	21	4.00	1,036.00
22	1.00	255.00	22			22			22			22	6.00	2,223.00
23	2.00	517.00	23	1.00	344.00	23			23			23	1.00	508.00
24			24	1.00	190.00	24			24			24		
25			25	1.00	212.00	25			25			25	1.00	692.00
26			26			26			26			26		
27			27			27			27	1.00	693.00	27		
28			28			28			28			28		
29			29			29			29			29		
30			30			30			30			30		
31			31			31			31			31		
32			32			32			32			32		
33			33			33			33			33		
34			34			34			34			34		
35			35			35			35			35		
36			36			36			36			36		
37			37			37			37			37		
38			38			38			38			38		
39			39			39			39			39		
40			40			40			40			40		
23.00	3,703.00		12.00	1,798.00		1.00	84.00		3.00	1,151.00		49.00	9,646.00	
Avg Vol 161.00			Avg Vol 149.83			Avg Vol 84.00			Avg Vol 383.67			Avg Vol 196.86		

Whitaker, Sellers & Duros
 Buck Knob Tract
 Martin County, Indiana

Stand Number: 1
 Number Acres: 41.0
 100% Inventory

Total

Beech Hardwood Sawtimber Board Feet LOCAL lgr			Red Elm Hardwood Sawtimber Board Feet LOCAL lgr			Blackgum Hardwood Sawtimber Board Feet LOCAL lgr			Sycamore Hardwood Sawtimber Board Feet LOCAL lgr			Post oak Hardwood Sawtimber Board Feet LOCAL lgr		
DBH	Trees	Vol	DBH	Trees	Vol	DBH	Trees	Vol	DBH	Trees	Vol	DBH	Trees	Vol
4			4			4			4			4		
5			5			5			5			5		
6			6			6			6			6		
7			7			7			7			7		
8			8			8			8			8		
9			9			9			9			9		
10			10			10			10			10		
11			11			11			11			11		
12			12			12			12			12		
13			13			13			13			13		
14			14	1.00	72.00	14	1.00	72.00	14			14	1.00	41.00
15	1.00	71.00	15			15	1.00	71.00	15			15		
16	2.00	171.00	16			16	1.00	61.00	16			16		
17			17			17			17			17		
18			18			18			18	1.00	300.00	18		
19	1.00	174.00	19			19			19			19		
20	1.00	238.00	20			20			20			20		
21			21			21			21			21		
22			22			22			22			22		
23			23			23			23			23		
24			24			24			24			24	1.00	257.00
25			25			25			25			25		
26			26			26			26			26		
27			27			27			27			27		
28			28			28			28			28		
29			29			29			29			29		
30			30			30			30			30		
31			31			31			31			31		
32			32			32			32			32		
33			33			33			33			33		
34			34			34			34			34		
35			35			35			35			35		
36			36			36			36			36		
37			37			37			37			37		
38			38			38			38			38		
39			39			39			39			39		
40			40			40			40			40		
5.00	654.00		1.00	72.00		3.00	204.00		1.00	300.00		2.00	298.00	
Avg Vol 130.80			Avg Vol 72.00			Avg Vol 68.00			Avg Vol 300.00			Avg Vol 149.00		

Total
Hardwood Sawtimber
Board Feet
LOCAL lgr

DBH	Trees	Vol
4		
5		
6		
7		
8		
9		
10		
11		
12		
13		
14	22.00	1,419.00
15	32.00	3,260.00
16	31.00	3,668.00
17	35.00	5,530.00
18	40.00	7,545.00
19	26.00	6,383.00
20	33.00	9,516.00
21	31.00	9,541.00
22	35.00	12,623.00
23	21.00	8,346.00
24	24.00	10,876.00
25	19.00	9,354.00
26	13.00	7,257.00
27	7.00	4,484.00
28	7.00	5,499.00
29	4.00	3,384.00
30	4.00	3,886.00
31	1.00	1,080.00
32	1.00	799.00
33	1.00	866.00
34		
35		
36		
37		
38		
39		
40		
387.00	115,316.00	
Avg Vol 297.97		

Total
Hardwood Pulpwood
Board Feet
LOCAL lgr

DBH	Trees	Vol
4		
5		
6		
7		
8		
9		
10		
11		
12		
13		
14		
15		
16		
17		
18		
19		
20		
21		
22		
23		
24		
25		
26		
27		
28		
29		
30		
31		
32		
33		
34		
35		
36		
37		
38		
39		
40		
0.00	0.00	0.00
Avg Vol 0.00		

Total
Pine Sawtimber
Board Feet
LOCAL lgr

DBH	Trees	Vol
4		
5		
6		
7		
8		
9		
10		
11		
12		
13		
14		
15		
16		
17		
18		
19		
20		
21		
22		
23		
24		
25		
26		
27		
28		
29		
30		
31		
32		
33		
34		
35		
36		
37		
38		
39		
40		
0.00	0.00	0.00
Avg Vol 0.00		

Total
Pine Pulpwood
Board Feet
LOCAL lgr

DBH	Trees	Vol
4		
5		
6		
7		
8		
9		
10		
11		
12		
13		
14		
15		
16		
17		
18		
19		
20		
21		
22		
23		
24		
25		
26		
27		
28		
29		
30		
31		
32		
33		
34		
35		
36		
37		
38		
39		
40		
0.00	0.00	0.00
Avg Vol 0.00		

Total
Chip'N'Saw
Board Feet
LOCAL lgr

DBH	Trees	Vol
4		
5		
6		
7		
8		
9		
10		
11		
12		
13		
14		
15		
16		
17		
18		
19		
20		
21		
22		
23		
24		
25		
26		
27		
28		
29		
30		
31		
32		
33		
34		
35		
36		
37		
38		
39		
40		
0.00	0.00	0.00
Avg Vol 0.00		