

# SCHULTHIES TIMBER SALE NOTICE

CR 650 S, Loogootee, IN 47553

**County:** Martin

**State:** Indiana

**Date:** Friday, January 21, 2022 at 10:15 AM Eastern (Martin County time). Bid opening is at the property.

**Type of Sale:** Sealed or phone bids. Twenty five percent down payment at contract signing, balance due October 1, 2022 or before logging begins, whichever comes first. Buyer will have until December 1, 2023 to remove timber.

**Owner:** Phillip and Danielle Schulthies

**Location:** Approximately 5.5 miles north of Haysville or 7.7 miles south of Loogootee in the NW ¼, NW ¼, Sec. 36, T2N, R5W, Rutherford Township. From Haysville go north on US 231 5.5 miles, or from US 50 in Loogootee go south on US 231 7.3 miles to CR 650 S. Look for signs for Alfordsville and Glendale F&W Area. Turn west on 650 and go 1.0 miles to the top of a hill. There is a new rock drive across the crop field on the right. The marked timber is in the woods across the field. The road does not go all the way to the woods and may be soft in spots. Use with caution. The bid opening will be where this drive meets 650. **See the map on back.**

**Contact:** Multi-Resource Management, Inc.

e-mail: [multiresourcengmt@gmail.com](mailto:multiresourcengmt@gmail.com)

Doug Brown 812-639-9724 (C)

Anthony Mercer 317-374-2826 (C)

**Remarks:** Trees are marked with blue paint. Seller reserves the right to accept or reject any or all bids. The owner and their agents make no guarantees of the board feet, number, or quality of trees listed in timber tally. Bidders are urged to satisfy themselves as to type, quality, and quantity of timber offered for sale. Buyer must have an Indiana Timber Buyer's License. Best management logging practices are required during the harvest operation. Purchaser will be required to carry general liability insurance and workers compensation. This is a Classified Forest but is NOT FSC certified. **A summary of diameter and volume distributions by species is available upon request.**

## TIMBER TALLY

SPECIES	# OF TREES	EST. VOLUME
Black Oak	32	13,073
White Oak *	26	10,989
Hickory	38	8,161
Sugar Maple	14	2,481
Blackgum	11	2,334
Beech	6	2,164
Red Oak	3	1,468
Sycamore	2	953
Ash	2	564
Black Cherry	2	553
Post Oak	1	255
Hackberry	1	153
Subtotals	138	43,148
Culls (X'd trees)	35	No Vol. Figured
TOTALS	173	43,148

\*Includes 3 white oaks with a blue "V" for veneer potential



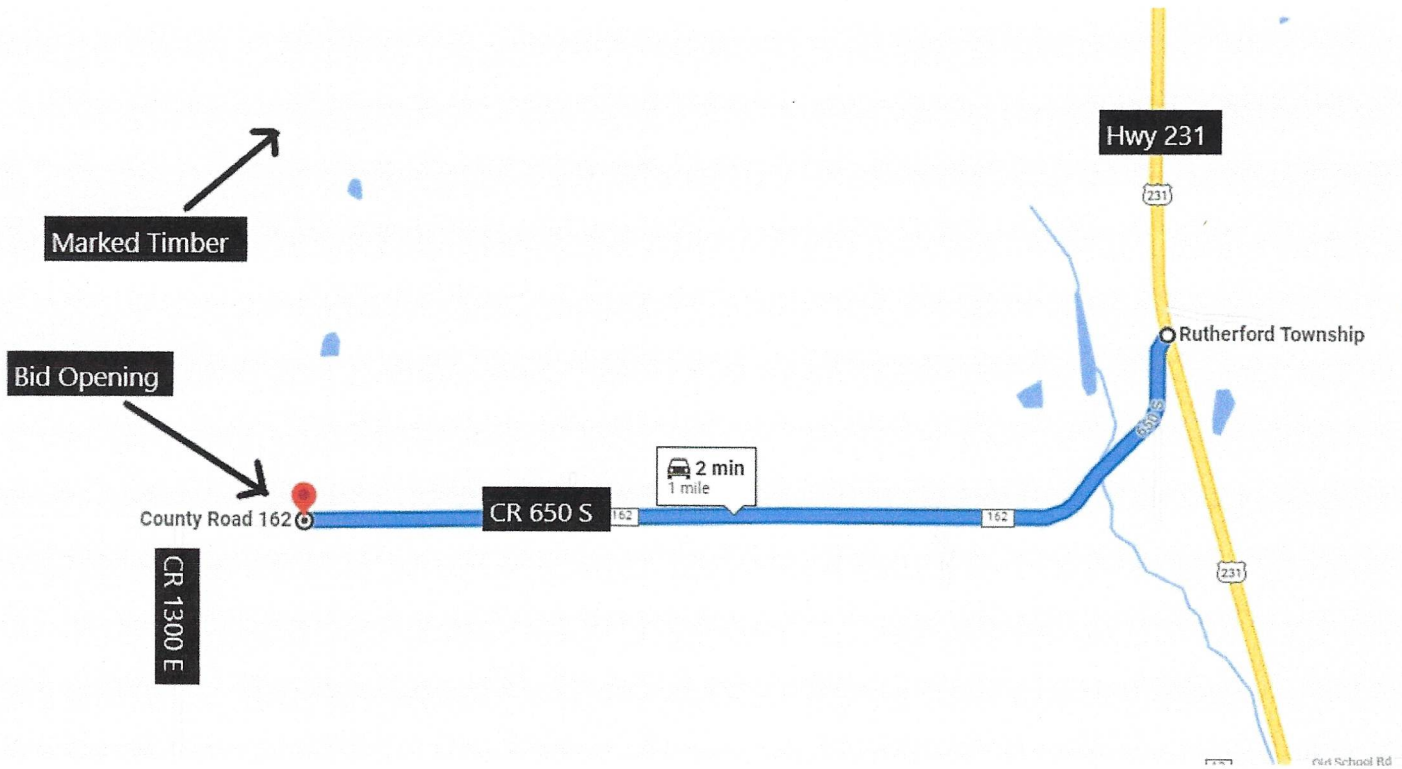



# Philip and Danielle Schulthies

Martin County, IN

Stand Number: 1  
 Number Acres: 20.3  
 100% Inventory

## Total

**Red Oak**  
 Hardwood Sawtimber  
 Board Feet  
 LOCAL Igr

DBH	Trees	Vol
4		
5		
6		
7		
8		
9		
10		
11		
12		
13		
14		
15		
16		
17		
18		
19		
20	1.00	341.00
21		
22		
23		
24		
25	1.00	505.00
26		
27		
28		
29		
30		
31	1.00	622.00
32		
33		
34		
35		
36		
37		
38		
39		
40		
<b>3.00</b>	<b>1,468.00</b>	
<b>Avg Vol 489.33</b>		

**Black Oak**  
 Hardwood Sawtimber  
 Board Feet  
 LOCAL Igr

DBH	Trees	Vol
4		
5		
6		
7		
8		
9		
10		
11		
12		
13		
14		
15	1.00	90.00
16	1.00	110.00
17	1.00	194.00
18		
19	1.00	241.00
20	2.00	515.00
21	3.00	1,022.00
22	6.00	2,164.00
23	2.00	694.00
24	2.00	1,074.00
25	2.00	790.00
26	3.00	1,723.00
27	2.00	696.00
28	3.00	1,719.00
29	1.00	523.00
30	1.00	571.00
31		
32	1.00	927.00
33		
34		
35		
36		
37		
38		
39		
40		
<b>32.00</b>	<b>13,073.00</b>	
<b>Avg Vol 408.53</b>		

**White Oak**  
 Hardwood Sawtimber  
 Board Feet  
 LOCAL Igr

DBH	Trees	Vol
4		
5		
6		
7		
8		
9		
10		
11		
12		
13		
14		
15	1.00	71.00
16	1.00	110.00
17	2.00	306.00
18	1.00	150.00
19	2.00	305.00
20	2.00	437.00
21	1.00	316.00
22	2.00	647.00
23		
24		
25	2.00	1,010.00
26	3.00	1,434.00
27	1.00	527.00
28	3.00	2,007.00
29	4.00	2,701.00
30		
31	1.00	968.00
32		
33		
34		
35		
36		
37		
38		
39		
40		
<b>26.00</b>	<b>10,989.00</b>	
<b>Avg Vol 422.65</b>		

**Hard Maple**  
 Hardwood Sawtimber  
 Board Feet  
 LOCAL Igr

DBH	Trees	Vol
4		
5		
6		
7		
8		
9		
10		
11		
12		
13		
14	1.00	84.00
15	1.00	143.00
16	3.00	257.00
17	4.00	692.00
18		
19		
20	3.00	636.00
21	1.00	270.00
22		
23		
24		
25		
26	1.00	399.00
27		
28		
29		
30		
31		
32		
33		
34		
35		
36		
37		
38		
39		
40		
<b>14.00</b>	<b>2,481.00</b>	
<b>Avg Vol 177.21</b>		

**Ash**  
 Hardwood Sawtimber  
 Board Feet  
 LOCAL Igr

DBH	Trees	Vol
4		
5		
6		
7		
8		
9		
10		
11		
12		
13		
14		
15		
16	1.00	110.00
17		
18		
19		
20		
21		
22		
23		
24	1.00	454.00
25		
26		
27		
28		
29		
30		
31		
32		
33		
34		
35		
36		
37		
38		
39		
40		
<b>2.00</b>	<b>564.00</b>	
<b>Avg Vol 282.00</b>		

**Black Cherry**  
 Hardwood Sawtimber  
 Board Feet  
 LOCAL Igr

DBH	Trees	Vol
4		
5		
6		
7		
8		
9		
10		
11		
12		
13		
14		
15		
16		
17	1.00	212.00
18		
19		
20	1.00	341.00
21		
22		
23		
24		
25		
26		
27		
28		
29		
30		
31		
32		
33		
34		
35		
36		
37		
38		
39		
40		
<b>2.00</b>	<b>553.00</b>	
<b>Avg Vol 276.50</b>		

**Hickory**  
 Hardwood Sawtimber  
 Board Feet  
 LOCAL Igr

DBH	Trees	Vol
4		
5		
6		
7		
8		
9		
10		
11		
12		
13		
14	4.00	254.00
15	4.00	404.00
16	5.00	678.00
17	7.00	980.00
18	3.00	564.00
19	4.00	860.00
20		
21	3.00	720.00
22	1.00	401.00
23	2.00	744.00
24	4.00	1,921.00
25	1.00	635.00
26		
27		
28		
29		
30		
31		
32		
33		
34		
35		
36		
37		
38		
39		
40		
<b>38.00</b>	<b>8,161.00</b>	
<b>Avg Vol 214.76</b>		

**Beech**  
 Hardwood Sawtimber  
 Board Feet  
 LOCAL Igr

DBH	Trees	Vol
4		
5		
6		
7		
8		
9		
10		
11		
12		
13		
14		
15		
16	1.00	110.00
17		
18		
19		
20		
21		
22		
23	1.00	344.00
24	1.00	454.00
25	1.00	286.00
26	1.00	399.00
27		
28		
29		
30	1.00	571.00
31		
32		
33		
34		
35		
36		
37		
38		
39		
40		
<b>6.00</b>	<b>2,164.00</b>	
<b>Avg Vol 360.67</b>		

**Blackgum**  
 Hardwood Sawtimber  
 Board Feet  
 LOCAL Igr

DBH	Trees	Vol
4		
5		
6		
7		
8		
9		
10		
11		
12		
13		
14		
15	1.00	90.00
16	2.00	239.00
17		
18	1.00	150.00
19	4.00	957.00
20	1.00	277.00
21	1.00	316.00
22	1.00	305.00
23		
24		
25		
26		
27		
28		
29		
30		
31		
32		
33		
34		
35		
36		
37		
38		
39		
40		
<b>11.00</b>	<b>2,334.00</b>	
<b>Avg Vol 212.18</b>		

**Sycamore**  
 Hardwood Sawtimber  
 Board Feet  
 LOCAL Igr

DBH	Trees	Vol
4		
5		
6		
7		
8		
9		
10		
11		
12		
13		
14		
15		
16	1.00	110.00
17		
18		
19		
20		
21		
22		
23		
24		
25		
26		
27		
28	1.00	843.00
29		
30		
31		
32		
33		
34		
35		
36		
37		
38		
39		
40		
<b>2.00</b>	<b>953.00</b>	
<b>Avg Vol 476.50</b>		

